

PLANTA SUBSUELO

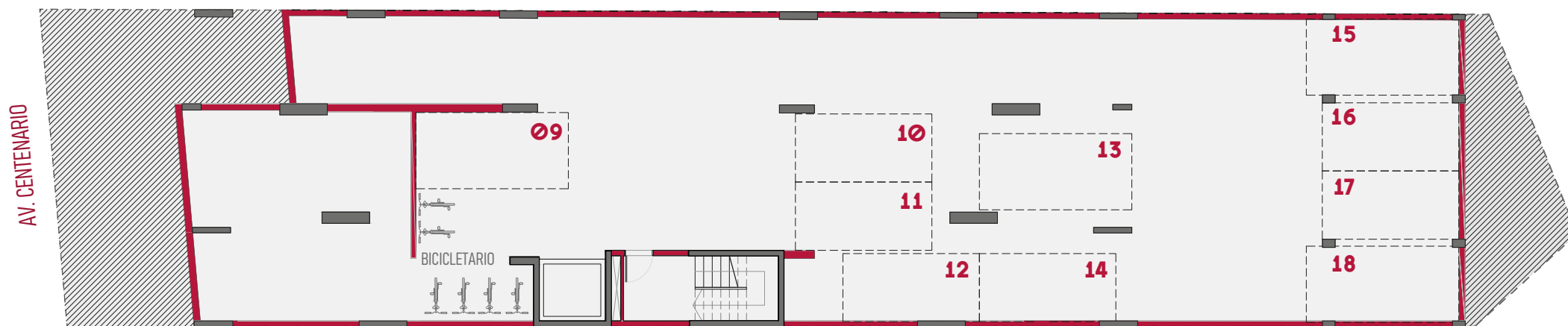

10 GARAJES BICICLETARIO

| | | | |
|-----------|-------------|-----------|-------------|
| GARAJE 09 | 2.40 x 4.80 | GARAJE 14 | 2.15 x 4.30 |
| GARAJE 10 | 2.15 x 4.30 | GARAJE 15 | 2.40 x 4.80 |
| GARAJE 11 | 2.15 x 4.30 | GARAJE 16 | 2.15 x 4.30 |
| GARAJE 12 | 2.15 x 4.30 | GARAJE 17 | 2.15 x 4.30 |
| GARAJE 13 | 2.40 x 4.80 | GARAJE 18 | 2.40 x 4.80 |